

SB Series Pellethane Split Repair Boots Installation Instructions (For Replacement Repairs)

STEP 1

Identify the damaged boot and select the proper BlueLine Repair Boot based upon the number of studs and the pipe OD. (See 2006 Catalog, Section 10 and Appendix 1)

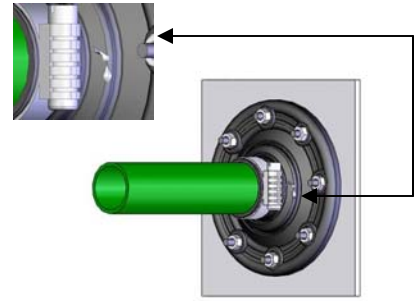

STEP 2

Remove band clamps from old fitting. Remove the nuts from the studs and store for future use. Remove old fitting. The old fitting will need to be cut off. Take care not to damage the secondary pipe.

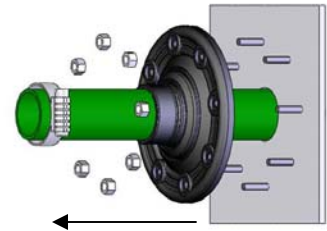

STEP 3

Install all Pellethane split components onto the pipe carefully. All Pellethane pieces must be rebonded back together with Blue Seal Glue. This is done by ensuring that the surfaces are clean and dry. Apply a liberal bead of Blue Seal and hold the seam closed securely until it is fused. It's helpful to use the clamps to loosely hold the boot closed during curing. Bonded connections should hold themselves closed within five minutes if there are no stresses on them. The Blue Seal glue will be fully cured in 40 minutes.

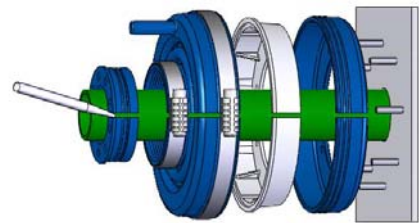

STEP 4

Once all components are bonded, apply a liberal bead of either Parasealant 626, or Bostik 1100FS to the underside of the seal. This will make the seal with the sump wall. Insert poly ring into the gasket and position it onto the studs and up against the sump wall.

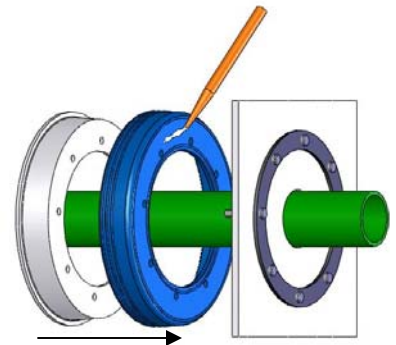

STEP 5

Reinstall nuts and tighten them in a star pattern.

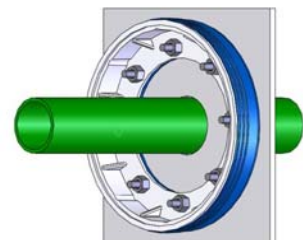

SB Series Pellethane Split Repair Boots Installation Instructions (For Replacement Repairs)

STEP 6

Apply a bead of Blue Seal Glue along the gasket rim and install the boot onto the seal. Install boot with fill tube at the 12:00 position. Install band clamp to secure the boot to the gasket.

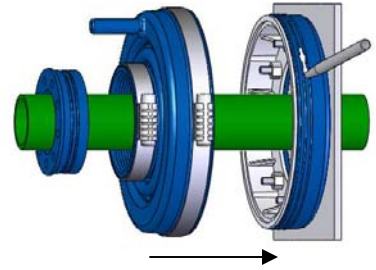

STEP 7

Position the insert into the boot if applicable, but do not tighten the clamp. This connection must remain loose through the filling stage to allow air to escape.

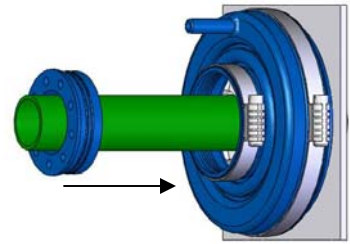

STEP 8

Fill the boot with either Parasealant 626, or Bostik 1100FS through the fill tube with the BlueLine pneumatic dispensing gun until the entire cavity is full. This will ensure that the sealant pushes back through the leak point and stops the leak.

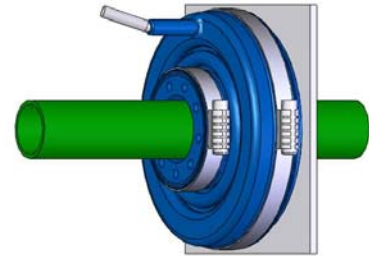

STEP 9

Once the boot is full, tighten clamps and allow sealant to fully cure.

